

SOLD



15 Moss Street, Slacks Creek

QCommercial Properties in conjunction with RE/MAX U is proud to exclusively market for sale an exciting vacant freehold commercial property located at 15 Moss Street, Slacks Creek.

This property is located in the renowned Moss Street within Slacks Creek's premiere industrial and commercial precinct. It is only 22km* south of Brisbane CBD and centrally located along the Brisbane-Gold Coast corridor. This freehold commercial property sits on a large 1,416m²* of land with circa 22m frontage and is situated in a strong mixed-use catchment of industrial, commercial and retail properties. Assets such as this rarely come to the market, as this precinct is very tightly held. This property is within minutes' drive of the Pacific Highway and other major transport nodes such as Gateway Motorway, Kingston and Logan Road. ...

Price: \$1,925,000

View: <https://remax-u.com.au/7201442>

Deepen Khagram

M 0409 557 421



RE/MAX Property Specialists,
Narrabeen

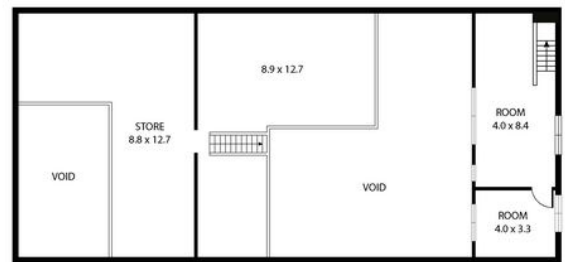
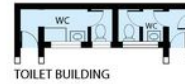
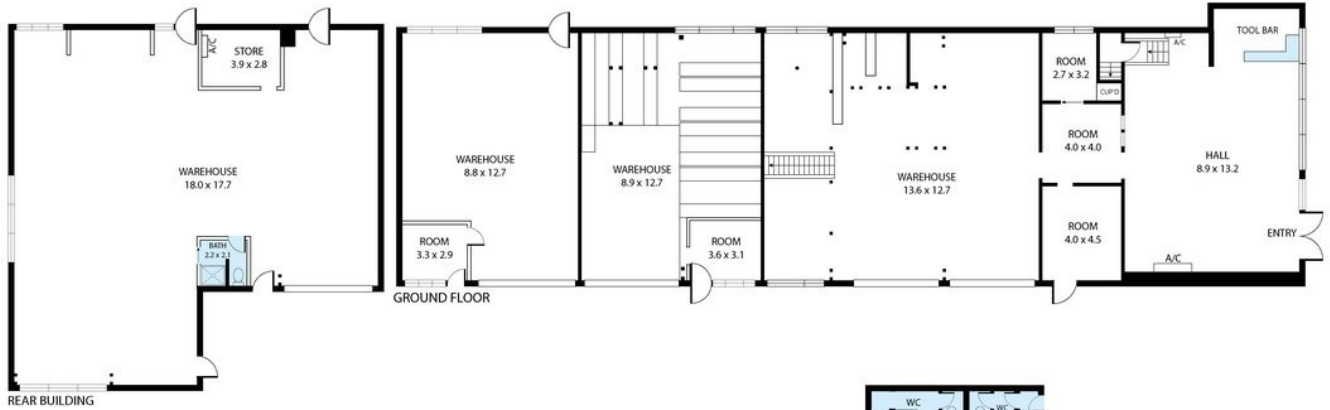

15 Moss Street, Slacks Creek 4127

TOTAL APPROX. FLOOR AREA 1,158 SQ.M

Whilst every attempt has been made to ensure the accuracy of the floor plan contained here, measurements of doors, windows, rooms and any other items are approximate and no responsibility is taken for any error, omission, or misstatement. This plan is for illustrative purposes only and should be used as such by any prospective purchaser.

GROUND FLOOR INCLUDING REAR : 833 SQ.M

FIRST FLOOR : 325 SQ.M

TOTAL AREA : 1,158 SQ.M